



EAST VILLAGE San Diego BIKE MAP



LEGEND

Bicycle Facilities

- Bicycle Path (off-street pathway)
- Bicycle Lane (on-street route with separate striped facility)
- Bicycle Route (on-street route with vehicular traffic)

Bicycle Resources

- Bike Rack Locations
- Bike Shop Locations
- Deco Bike Locations

Places of Interest

- East Village Landmarks
- Schools

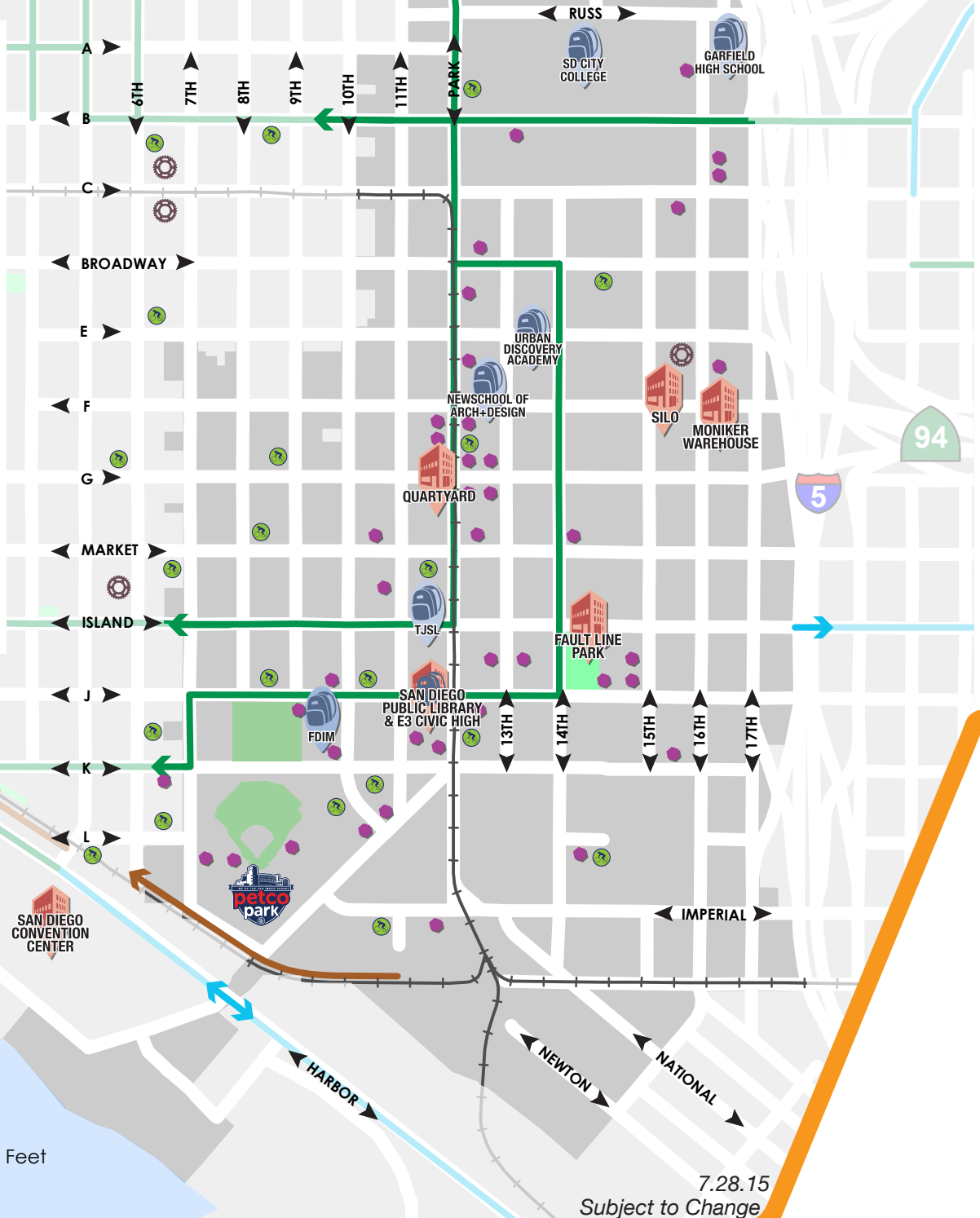

7.28.15

Subject to Change



Map brought to you by:
The East Village Association, Inc. (EVA)
 A non profit corporation that manages the East Village Business Improvement District.
<http://eastvillagesandiego.com>



DESTINATION DISTANCES

- From the Center of East Village (Park & Market)**
1. San Diego Zoo 2.0 mi
 2. Balboa Park (El Prado) 2.2 mi
 3. Little Italy 1.5 mi
 4. Ferry Terminal to Coronado 1.5 mi
 5. USS Midway 1.5 mi
 6. Seaport Village 1.1 mi
 7. Horton Plaza 0.8 mi
 8. San Diego Convention Center 0.7 mi
 9. Gaslamp Quarter 0.4 mi

MAP LEGEND

- East Village BID Boundary
- Downtown Destinations
- Existing Bicycle Facilities
- Bicycle Path
- Bicycle Lane
- Bicycle Route

DOWNTOWN DESTINATIONS



WELCOME TO EAST VILLAGE

East Village is San Diego's largest downtown neighborhood encompassing 130 blocks, between Seventh Avenue east to 18th Street. More than 700 businesses are located in the thriving urban enclave, including restaurants, hotels, art galleries, PETCO Park, and the new San Diego Central Library.

Several educational institutions are also located in East Village including Thomas Jefferson School of Law (TJSL), NewSchool of Architecture + Design, Fashion Institute of Design and Merchandising (FDIM), and San Diego City College. Continuing urban development and the steady growth of new businesses creates a diverse, ever-evolving, and vibrant community with a unique mix of arts, culture, education, and entertainment.

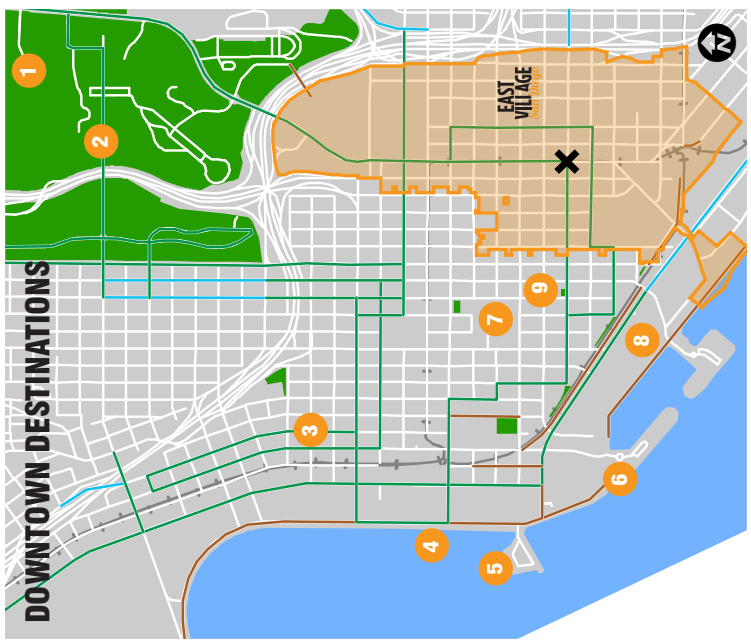

HOW TO...

Properly Secure Your Bike

1. Find a bicycle rack or sturdy pole (Avoid scaffolding, railings and fencing)
2. With a quick release front tire, remove the front tire and secure to the back tire and frame as seen in example A
3. Otherwise, secure a wheel and frame to the rack and use a chain to secure the other wheel (example B)
4. Avoid securing bike by the top tube and never leave bike unsecured

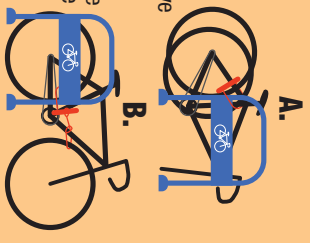

Bring Bikes on Transit

1. Squeeze handle to lower the bike rack
2. Load your bicycle into an empty slot
3. Raise the support arm up and over the front tire

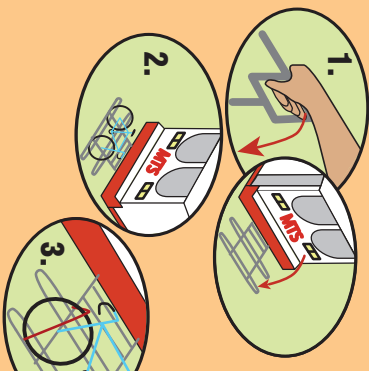

RIDING TIPS

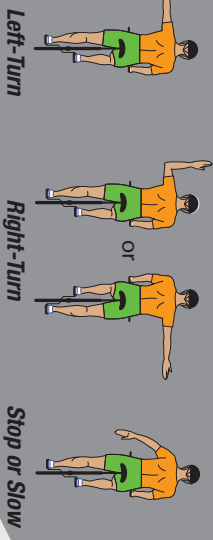

Don't Forget to..

1. Make eye contact with drivers
2. Wear bright clothes
3. Wear a helmet

Nighttime Equipment

1. Front and rear lights or reflectors
2. Wheel and Pedal reflectors



Important Contact Information

- In case of emergency: Call 9.1.1
- Report a lost or stolen bike: 619.531.2000
- Report a pothole: 619.527.7500